

FORM NO. 1.

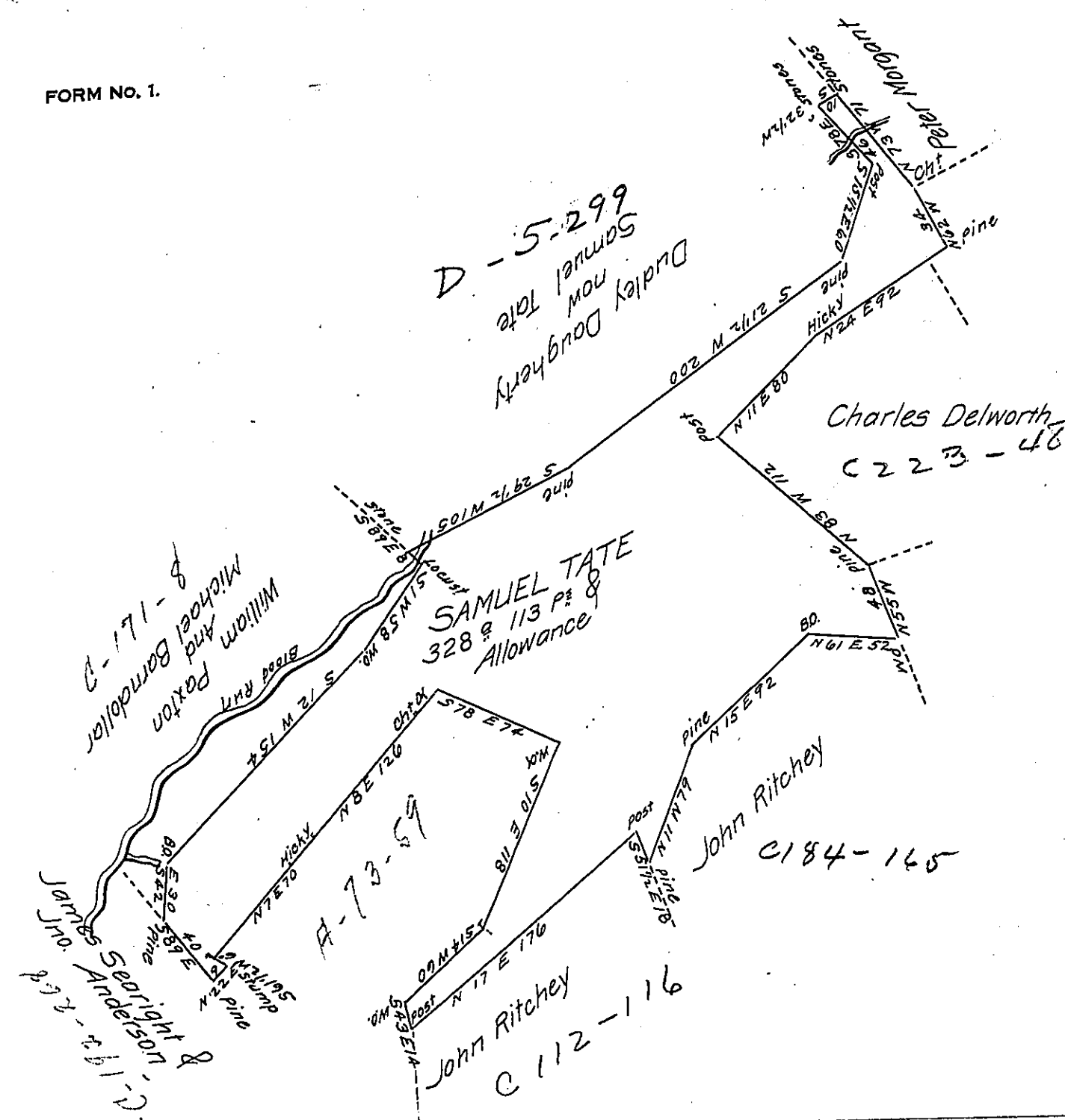

Draught of a Tract of land Situate in Providence Township Bedford County on both Sides of the Warriors Ridge Surveyed for Samuel Tate 16th Day of April 1808 in pursuance of a Warrant dated the 18th Day of January 1808 Containing 328 & 113 P & Allowance of Six Per Cent for Roads & See

To Samuel Cochran Esq^r John Anderson
 Surveyor General Deputy Survey

IN TESTIMONY that the above is a copy of the original remaining on file in the Department of Internal Affairs of Pennsylvania, made conformably to an Act of Assembly approved the 16th day of February 1833, I have hereunto set my hand and caused the Seal of said Department to be affixed at Harrisburg, this twenty-ninth day of April 1907

Geo. R. Brown
 Secretary of Internal Affairs.